



2/21-23 Bligh St, Wollongong, NSW 2500

\$450,000 - \$480,000

Apartment 2  1  1 



An opportunity comes knocking!

This modern two bedroom or one bedroom plus study apartment has an array of features to satisfy your needs. Situated in an immaculate complex, it features a combined kitchen and living area, which opens up into a wrap around covered courtyard. Also included is an internal laundry and modern bathroom, full security entry plus security basement parking. Conveniently positioned close to Beaton Park Leisure Centre, University of Wollongong, Bowling, Tennis Club, preschool and Gwynneville village shop. An easy walk to Wollongong hospital, beaches and city. Good first home or investment.

Open for Inspection

By Appointment.

Council rates - \$317pq*

Water rates - \$240pq*

Strata levies - \$791pq*

Rental amount - \$460pw. Currently tenanted

*All figures are approx.

Listed By



Angela Ellenis
Phone: (02) 4226 1262



Listing Number: 2796822

Floorplan

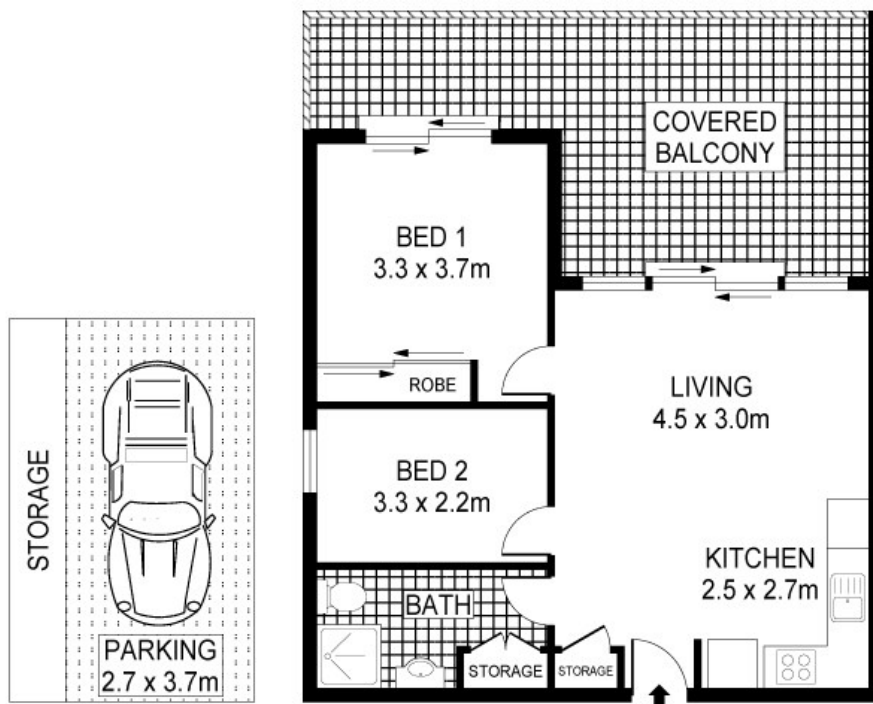

DETACHED



PLANS SHOWN ONLY INDICATIVE OF LAYOUT. DIMENSIONS ARE APPROXIMATE.
 Ref: No 63236

INT : 52m²
 EXT : 41m²
 PARKING : 15m²
 TOTAL : 93m²

2/21-23 BLIGHT STREET

WOLLONGONG